



CUSTOMLED

Download FULL SIZE Instructions

<https://www.customled.com/xdiaveltpu-v2>

Diavel 1260 & XDiavel Smart Turn Signal Integrator Kit (GEN 2) Installation Instructions

We thank you for purchasing this Custom LED product, which includes a custom designed and manufactured Run-Brake-Turn control module provided with a harnesses specific for installation on the **2019-2023 Ducati Diavel 1260** and **2016-2023 XDiavel**. Please read these instructions in their entirety before proceeding, and then carefully follow the procedure step by step as you install this product. If you need any installation or technical support, please contact support@customled.com or call +1-201-477-0031 during business hours.

Part Number: XDIAB-STPU-REV2
(U.S. Patent # 8,588,997)

Package Contents:

- Smart Turn Signal Integrator Module
- Double Sided Tape
- Zip Ties
- Instructions

Application:

This kit has been designed by Custom LED to fit either the Ducati Diavel 1260, or Ducati XDiavel.

Installation:

1. Secure motorcycle on level surface. Remove seat. Disconnect negative battery cable from the battery.
2. Install the provided kit according to the "Illustrated Installation Instructions." Follow the XDiavel or Diavel 1260 illustrations accordingly.
3. Re-connect the battery's negative battery cable to the negative of the battery.
4. Be sure that the Smart Turn Signal Integrator kit installation location will not interfere with the secure placement of the seat. Secure with tie-wraps, tape or other means so that control unit and wires will not move.

Initial Setup & Operation Test

5. Turn the ignition key on and check operation as follows:
 - Running Lights: OEM tail lights are illuminated dimly. **Note: You may hear a faint buzzing sound - this is completely normal.**
 - Apply Right Turn Signal and check operation of right turn signal, should flash off to bright. Disable turn.
 - Apply Left Turn Signal and check operation of left turn signal, should flash off to bright. Disable turn.
 - Apply Brake Light. Check to see that both tail lights flash 4 times then remain bright.



ATTENTION



Please read all warning Information below before Installation

Important: For this installed system to be legal for turn signals, you must be in a country that allows red turn signal lamps in the rear.

Important: This system is designed to work with the OEM rear tail lights and OEM blinker lamps if desired.

Important: Remove any existing Run-Brake-Turn or similar aftermarket modules prior to installing this unit.

Caution: Never install a trailer adapter, trailer harness or trailer controller downstream of this unit, a trailer adapter, harness or controller must be installed on the input side of this unit.

Caution: This unit is designed for a maximum load of 5 watts per channel as are the OEM tail lights. Do not attempt to connect any additional lamps or devices to the outputs. Overloading the unit could cause damage to the unit and cause the unit to malfunction.

Important: Module must be secured after installation. Find safe area away from any moving parts and out of the way of normal operation of the bike. Use Tie-wraps, tape, or other means to secure. Custom LED is not liable for damage to the module or the bike as a result of improperly securing the module.

Notice: This product is Not DOT approved.

Questions? Call us at: +1 (201) 477-0031 Monday-Friday 9:00AM-4:00PM EST

Programming the Module (*optional*)

6. The Smart Turn Signal Integrator Kit allows you to change or engage the following features of operation using the Pushbutton located on the control module to enter the respective Menu number.

- Menu 1: Turn on and off the **Startup Sequence** (default: ON)
- Menu 2: Choose the **Brake Alert Pattern** (default: Pattern 9)
- Menu 3: Adjust the **Running Light Brightness** within a preset range (default: medium)
- Menu 4: Engage **Strobe Mode** (overrides all tail light operations! reset with ignition cycle)
- Menu 5: Engage **Demo Mode** (useful for bike shows and displays. reset with ignition cycle)
- Menu 6: **Reset Factory Defaults**

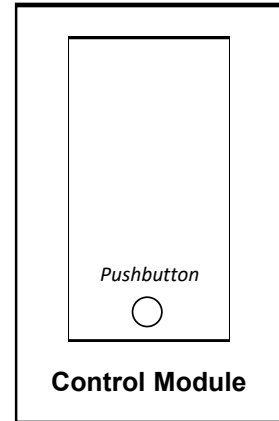

Programming steps and instructions (follow exactly as written)

- Step 1: With Ignition OFF, depress and hold pushbutton switch on control module.
- Step 2: Turn ON ignition while depressing pushbutton. (Program Mode Enabled is indicated by tail lights fading up and down rapidly.)
- Step 3: Release pushbutton.
- Step 4: Choose menu item you wish to modify, and depress and release the pushbutton the corresponding number of times. *Brake Alert Example:* to change/select the Brake Alert Pattern, depress and release the pushbutton 2 times for menu #2.
- Step 5: **WAIT** for tail light to blink back same number of times to confirm selection then will immediately show current setting for that menu. *Brake Alert Example:* tail lights will blink twice if entering menu number 2, and then show currently selected Brake Alert pattern.
- Step 6: Depress and release the pushbutton switch to change the setting to the next option in that menu. *Brake Alert Example:* depress and release the pushbutton to select and view the next available Brake Alert pattern.
- Step 7: Save your selection simply by turning off the Ignition. The Control Module will remember your setting until the next time you change it.
- Step 8: Turn ON ignition to check that your setting has been stored. *Brake Alert Example:* Depress brakes
- Step 9: Repeat procedure from Step 1 to change or engage additional features of operation if desired.

Brake Alert Pattern Descriptions:

- Pattern 1: Four Flashes then Solid.
- Pattern 2: Four Flashes, Solid for 3 Seconds, Repeat. Pattern 3: Seven Flashes then Solid.
- Pattern 4: Seven Flashes, Solid for 3 Seconds, Repeat.
- Pattern 5: Quad Strobe, Solid for 1 Second, Quad Strobe, Solid.
- Pattern 6: Quad Strobe, Solid for 1 Second, Quad Strobe, Solid for 3 Seconds, Repeat.
- Pattern 7: Strobe Mode Cycle for 3 Seconds, Solid.
- Pattern 8: Strobe Mode Cycle, Solid for 3 Seconds, Repeat.
- Pattern 9: 4 Quick Strobes, Solid (Factory Default).
- Pattern 10: 10 Quick Strobes, Solid.
- Pattern 11: Constant Quick Strobes (while braking).
- Pattern 12: No Brake Alert (solid red).

Test & Finish

7. Turn ON ignition and Test Operation based on your desired settings. Once programming is complete, re-install the seat. Installation is complete.

2016-2023 Ducati XDiavel

GEN 2 Smart Turn Signal Integrator Kit- Illustrated Installation Instructions

1) Remove the riders seat, and locate the two tail light connectors close to the passenger seat as shown.

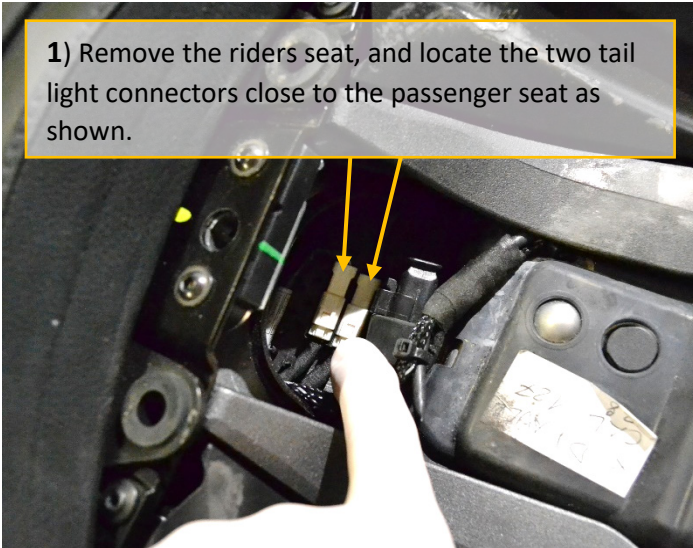

2) Disconnect the two connectors (depress the release tab) and fish cable shown from under frame rail.

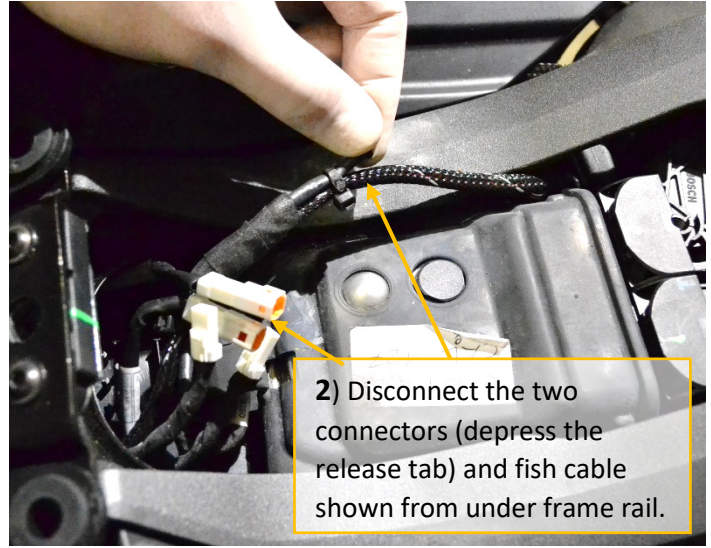

3) Install the provided harness with the two 3-wire connectors, into the mating tail light connectors.

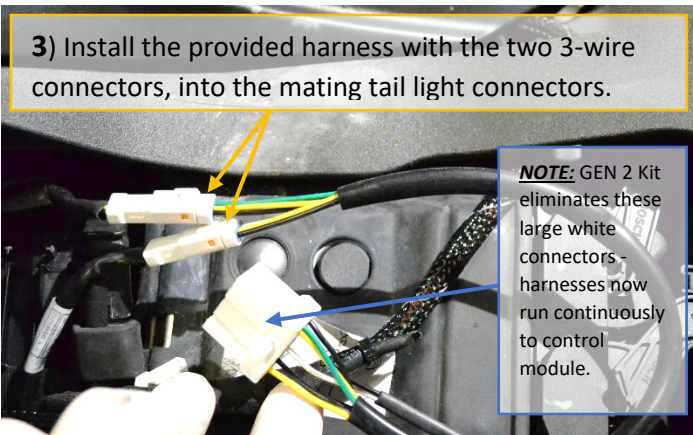

NOTE: GEN 2 Kit eliminates these large white connectors - harnesses now run continuously to control module.

NOTE: Harness may appear different than pictured. Harness with VIOLET wire connects to LEFT side OEM tail light, and BLUE wire to RIGHT side OEM tail light.

4) Place the mated tail light connectors back in their holders, and tuck the harness under the frame rail as shown.

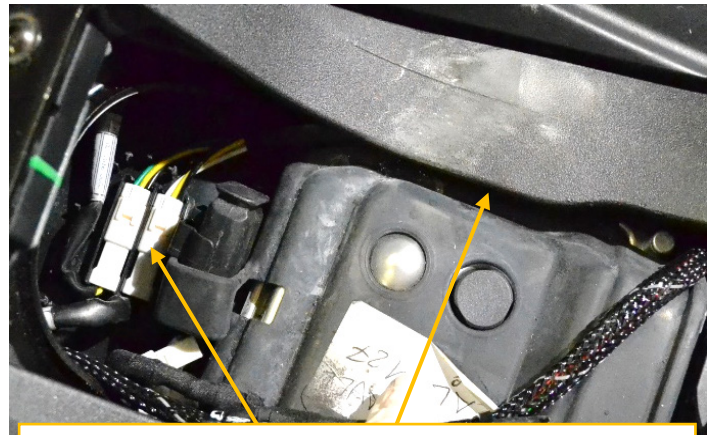

6) Disconnect the fuel sensor wire from the left side of the fuel tank by pulling it straight towards the rear of the motorcycle.

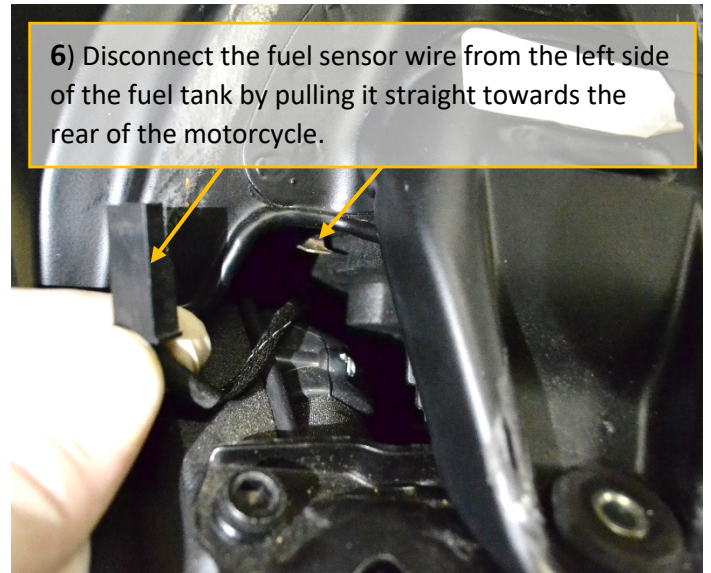

5) Remove the bolt securing the fuel tank.

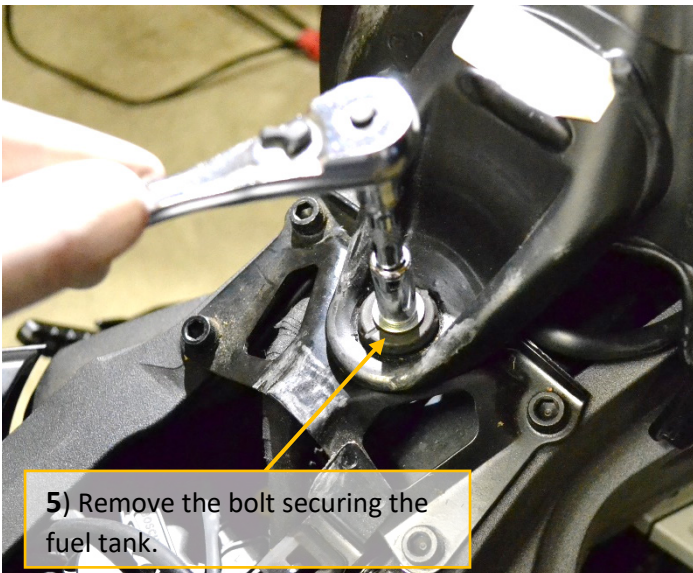

Ducati XDiavel

(continued)

7) CAREFULLY prop up the fuel tank (only about 4 inches) with a piece of wood placed under the securing bolt bracket. Make sure it's secure!

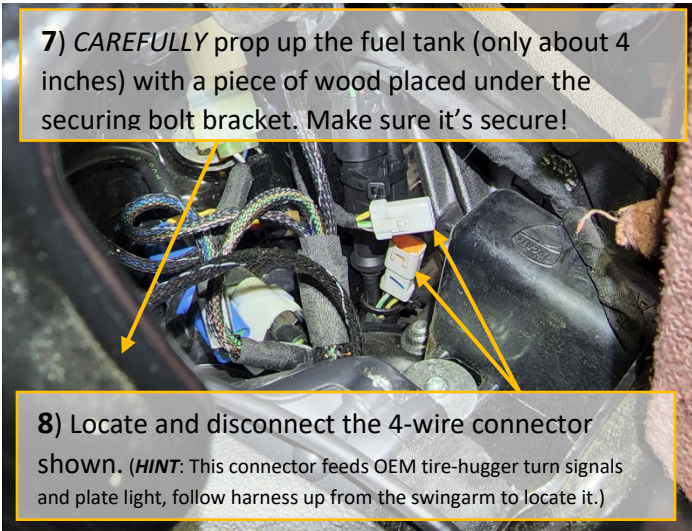

8) Locate and disconnect the 4-wire connector shown. (HINT: This connector feeds OEM tire-hugger turn signals and plate light, follow harness up from the swingarm to locate it.)

9) Locate the kit harness with the two 4-wire connectors, and fish it through the opening under the tank support as shown.

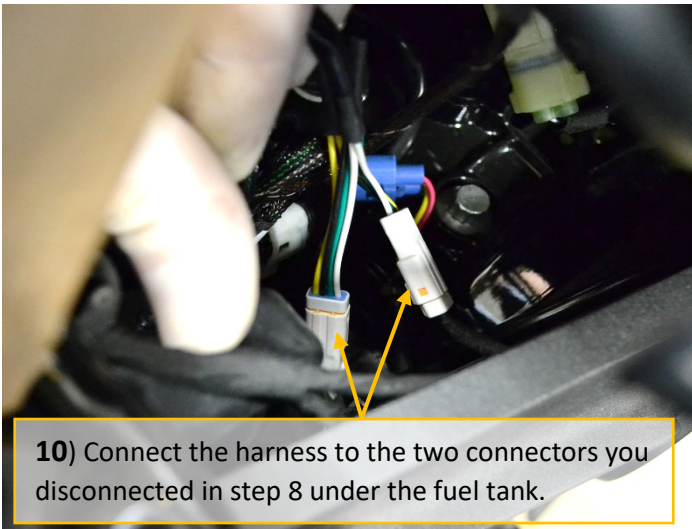

10) Connect the harness to the two connectors you disconnected in step 8 under the fuel tank.

11) Connect the remaining 3-wire connector (black, yellow, red wires) to either open tail light connector removed in step 2. (One connector will remain unused)

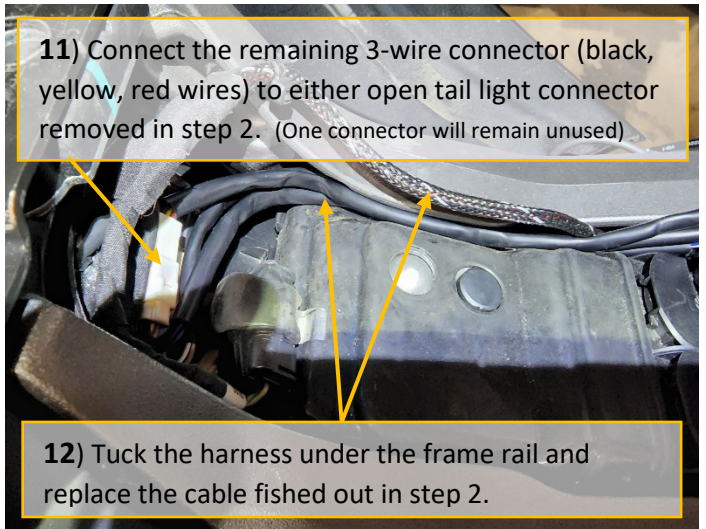

12) Tuck the harness under the frame rail and replace the cable fished out in step 2.

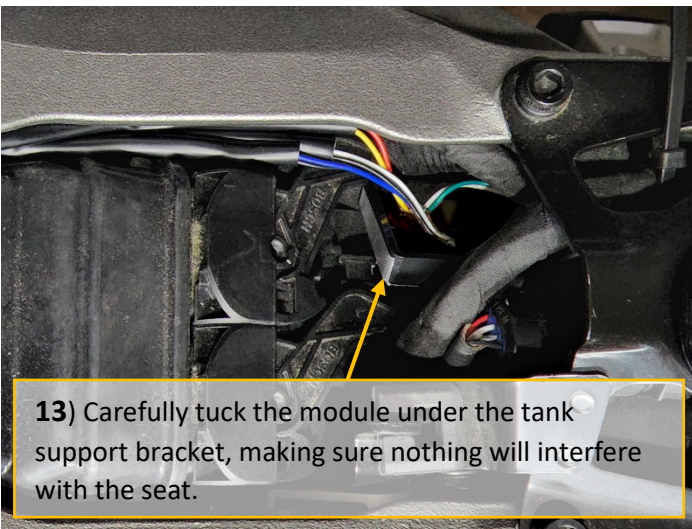

13) Carefully tuck the module under the tank support bracket, making sure nothing will interfere with the seat.

14) Lower fuel tank, reconnect fuel sensor wire, refasten the fuel tank with securing bolt, and reinstall the seat.

15) Rant and Rave about Custom LED to everyone, and enjoy! 😊

2019-2023 Ducati Diavel 1260

GEN 2 Smart Turn Signal Integrator Kit- Illustrated Installation Instructions

1) Remove the riders seat, if equipped move this box out of the way to gain access to the left tail light connector.



2) Disconnect the left tail light connector by depressing the locking tab and pulling apart the connectors.



3) Find the 4-pin connector near the tank support that feeds the OEM tire hugger turn signals and plate light. **Hint:** Follow the harness from the swingarm, all the way up under the seat/tank area. If the connector runs under the tank goto step 4. If the connector is accessible without lifting the tank, skip to step 6 (there are different 1260 builds).

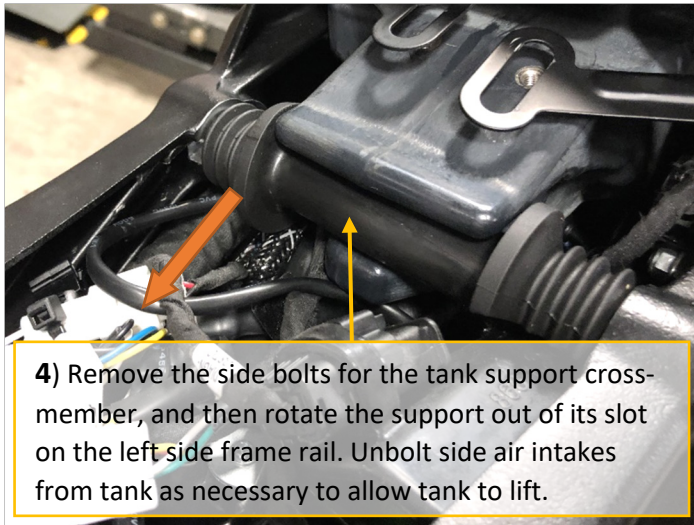

5) Lift the fuel tank about 4" and support it to stay elevated. Locate this 4-wire connector shown under the tank. Loosen the OEM rubber tie strap.



4) Remove the side bolts for the tank support cross-member, and then rotate the support out of its slot on the left side frame rail. Unbolt side air intakes from tank as necessary to allow tank to lift.

6) Disconnect the 4-wire connector, and connect the provided 4-wire harness inline with connectors.



7) Re-use OEM rubber tie strap to secure the connectors.

NOTE: GEN 2 Kit eliminates this large white connector- harnesses now run continuously to control module.

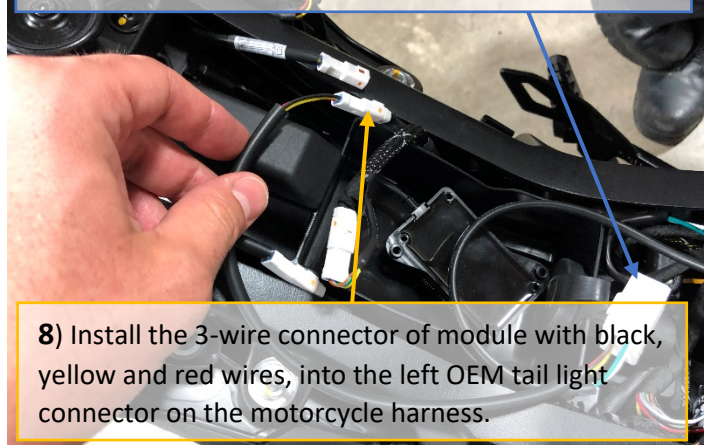

8) Install the 3-wire connector of module with black, yellow and red wires, into the left OEM tail light connector on the motorcycle harness.

Ducati Diavel 1260

(continued)

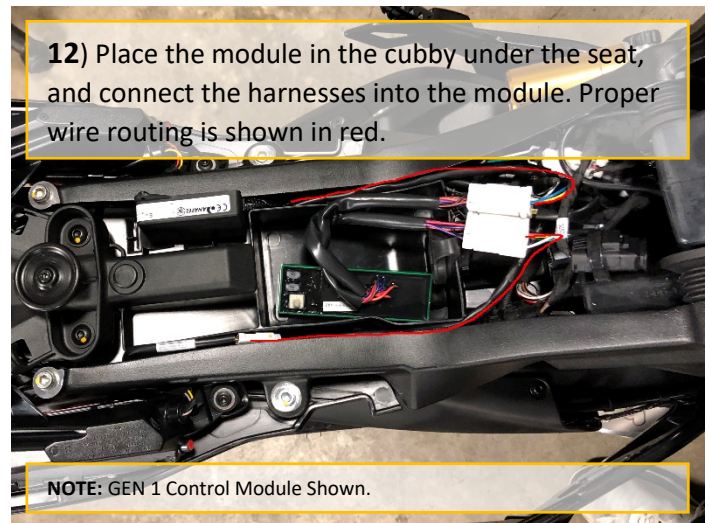
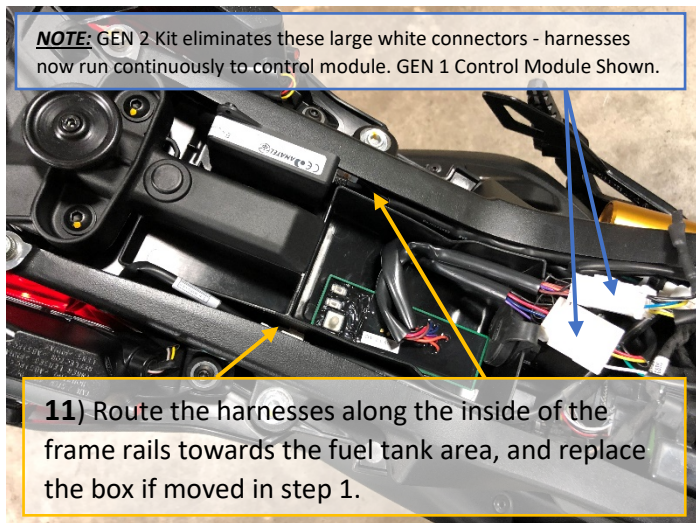
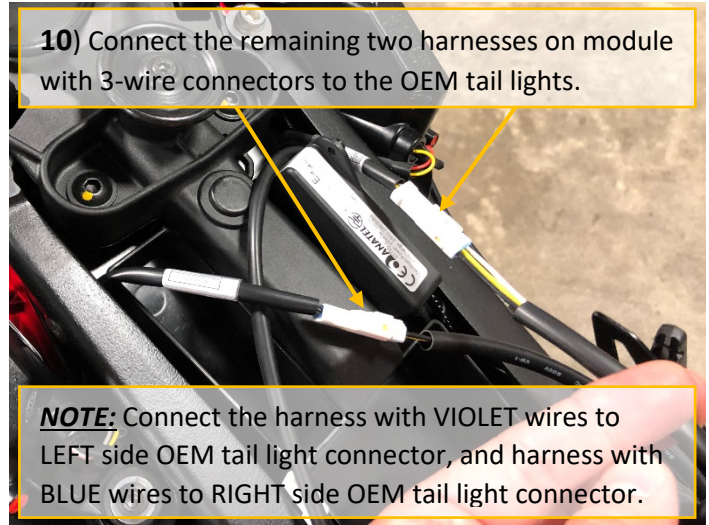
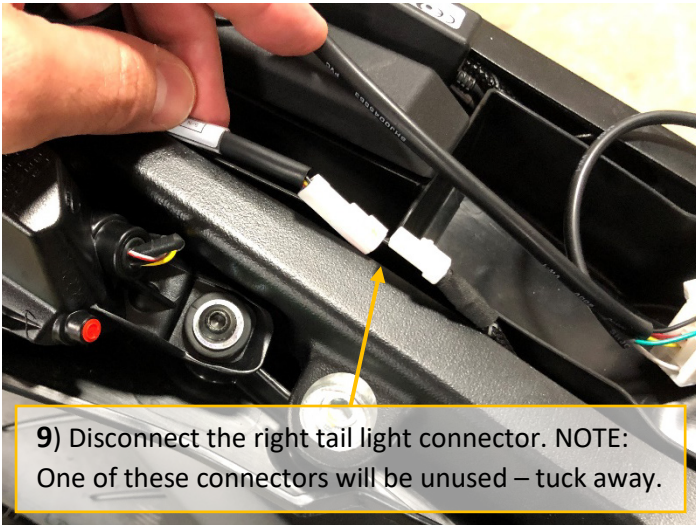

13) Affix the module to the cubby using the provided double-sided adhesive tape.

14) Secure loose wiring using tie-straps.

15) If removed, re-install the fuel tank support in the opposite procedure as step 3

16) Rant and Rave about Custom LED to everyone, and enjoy! 😊